



1001 Trout Brook Crossing  
Rocky Hill, CT 06067-3910  
Telephone: (860) 571-5100  
FAX: (860) 571-5465

## Product Description Sheet 250 ml Bottle Hand Pump

Part # 97001

North American Engineering Center, August 2005

### PRODUCT DESCRIPTION

The LOCTITE® 250 ml. Bottle Hand Pump is a portable, precision, bottle-top applicator that threads firmly onto any 250 ml. anaerobic bottle. This manual system will dispense Loctite threadlocker adhesives and retaining compounds from 0.01 to 0.04 ml and viscosities up to 30,000 cPs. It is designed to dispense at any angle without leaks and eliminates waste. In addition, it requires no flushing, power, or air source.

### PRODUCT FEATURES

- Adjustable positive displacement; 0.01 ml.- 0.04 ml. of product.
- Allows user to control amount and positioning of the adhesive.
- Converts product package into a portable dispenser.
- Applicator nozzle accepts a variety of dispensing needles.

### Technical Data

- Size: 4" (H) x 5.75" (W) x 1.5" (D)
- Weight: 125 grams

### Loctite® 250 ml Bottle Hand Pump Includes:

- Hand Pump
- Needle Kit P/N 984127
- Operating Manual

### Loctite® Brand Accessories and Spare Parts (not included):

- Nozzle P/N 993174
- Tubing, 186" ID x .330" OD x 12" long, P/N 993163
- Showcase Needle Variety Kit P/N 98439

**NOTE: The unit is not suitable for cyanoacrylate adhesives or primers.**

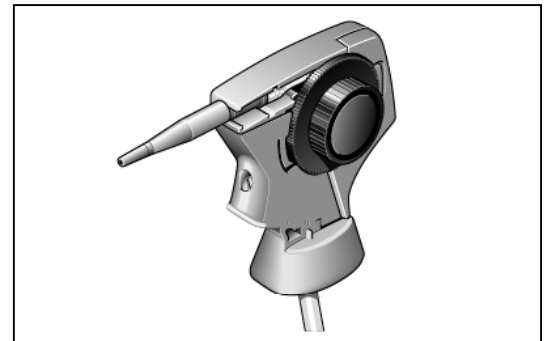

NOT FOR PRODUCT SPECIFICATIONS

Loctite is a TM of Henkel Corporation, U.S.A. © Copyright 2004. Henkel Corporation. All rights reserved

