

# MALLEABLE IRON

# MERCHANT COUPLING – GALV.

## Features

- 150 Class Malleable Iron Pipe
- 100% Inspected and tested

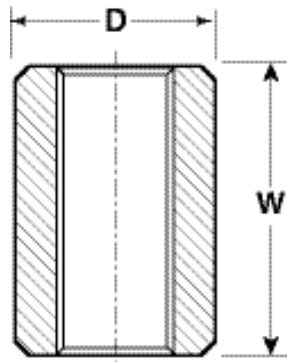

Dimensions are in inches

Part No.	Size	D	W
2KME5	1/8"	0.56	0.96
2KME6	1/4"	0.72	1.06
2KME7	3/8"	0.87	1.16
2KME8	1/2"	1.07	1.34
2KME9	3/4"	1.32	1.52
2KMF1	1"	1.60	1.67
2KMF2	1-1/4"	1.97	1.93
2KMF3	1-1/2"	2.23	2.15
2KMF4	2"	2.74	2.53
2KMF5	2-1/2"	3.59	2.88
2KMF6	3"	4.28	3.18
2KMF7	4"	5.40	3.69

Part No.	Size	
2KME5	1/8"	Threaded
2KME6	1/4"	Threaded
2KME7	3/8"	Threaded
2KME8	1/2"	Threaded
2KME9	3/4"	Threaded
2KMF1	1"	Threaded
2KMF2	1-1/4"	Threaded
2KMF3	1-1/2"	Threaded
2KMF4	2"	Threaded
2KMF5	2-1/2"	Threaded
2KMF6	3"	Threaded
2KMF7	4"	Threaded

- Materials meet ANSI/ASTM A - 197 standard
- Dimensions meet ANSI/ASME B16.3, B16.14 & B16.39 standard
- Threads meet ANSI B1.20.1