

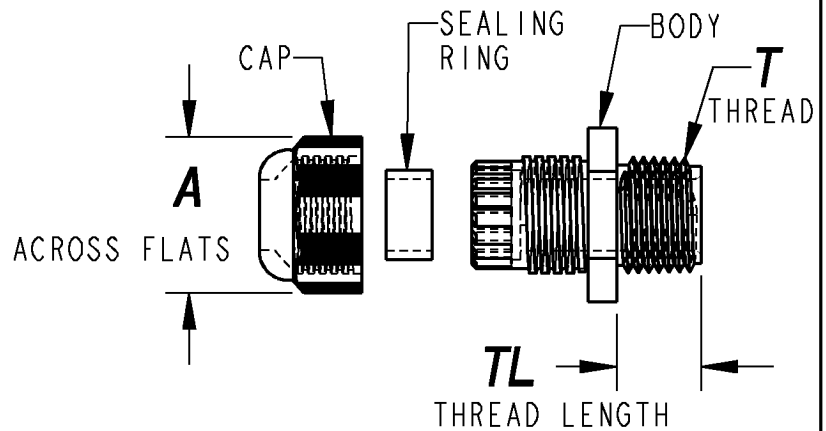

T&B Portable Cord Fittings

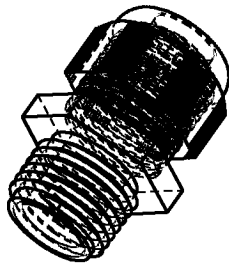

MATERIAL: BODY AND CAP- POLYANIDE 6
 SEALING RING: NEOPRENE
 COLOR: GRAY (RAL 7001)
 BLACK (RAL 9005)
 PROTECTION CLASS: IP 68, 5 BAR
 TEMPERATURE RANGE: -30°C TO 80°C PERMANENT
 OPERATING TEMPERATURE: UP TO +150°C INTERMITTENT
 PG & ISO CABLE GLANDS ARE NOT UL LISTED

CATALOG NUMBER	SIZE	COLOR	MAXIMUM CLAMPING RANGE	MINIMUM CLAMPING RANGE	ACROSS FLATS	THREAD	THREAD LENGTH
CC-PG36-G	PG36	GRAY	1.260	.867	2.086	PG36	.512
CC-PG29-G	PG29	GRAY	.984	.709	1.653	PG29	.433
CC-PG21-G	PG21	GRAY	.709	.511	1.300	PG21	.433
CC-PG16-G	PG16	GRAY	.551	.394	1.063	PG16	.394
CC-PG13.5-G	PG13.5	GRAY	.473	.236	.945	PG13.5	.354
CC-PG11-G	PG11	GRAY	.394	.197	.866	PG11	.315
CC-PG9-G	PG9	GRAY	.315	.157	.748	PG9	.315
CC-PG7-G	PG7	GRAY	.256	.118	.590	PG7	.315
CC-ISO32-G	ISO32	GRAY	.984	.709	1.653	ISO32	.590
CC-ISO25-G	ISO25	GRAY	.709	.511	1.300	ISO25	.590
CC-ISO20-G	ISO20	GRAY	.473	.236	.945	ISO20	.394
CC-ISO16-G	ISO16	GRAY	.394	.197	.866	ISO16	.394
CC-NPT1-B	1"	BLACK	.984	.709	1.654	1-11 1/2 NPT	.790
CC-NPT1-G	1"	GRAY	.984	.709	1.654	1-11 1/2 NPT	.790
CC-NPT3/4-B	3/4"	BLACK	.709	.511	1.299	3/4-14 NPT	.590
CC-NPT3/4-G	3/4"	GRAY	.709	.511	1.299	3/4-14 NPT	.590
CC-NPT1/2-B	1/2"	BLACK	.551	.394	1.063	1/2-14 NPT	.590
CC-NPT1/2-G	1/2"	GRAY	.551	.394	1.063	1/2-14 NPT	.590
CC-NPT3/8-B	3/8"	BLACK	.394	.197	.866	3/8-18 NPT	.590
CC-NPT3/8-G	3/8"	GRAY	.394	.197	.866	3/8-18 NPT	.590

GENERAL NOTES

- ALL DIMENSIONS ARE FOR REFERENCE ONLY.
- DIMENSIONS IN BRACKETS [] ARE IN METRIC UNITS.

REVISIONS

- | | |
|---|--|
| 1 | SEE ERN 2012987 FOR APPROVAL SIGNATURES & RELEASE DATE. PROJECT NO: RM401187 |
|---|--|

Thomas & Betts
www.tnb.com

DESCRIPTION: **NON-METALLIC NPT THREAD CABLE GLAND**

ORIGINAL PROJECT NO / (ERN NO) RM401810 / (2002527)	SHEET NO: 1 OF 1	REV. NO: 1	DRAWING NO: WSD-000004
---	----------------------------	----------------------	----------------------------------