

1. MATERIAL: 6/6 NYLON WITH BUNA N GLAND.
2. TEMPERATURE RANGE: -22° F (-30° C) TO 212° F (100° C)
3. COLOR CODE: GRAY CAT. NO. LAST LETTER - GA  
BLACK CAT. NO. LAST LETTER - BA
4. CORD CONNECTORS ARE HALOGEN AND SILICON FREE.  
PROTECTION CLASS: IP 68 PER DIN 40050 UP TO  
70 PSI (5 BAR) WATER PRESSURE.
5. UL LISTED AND CSA CERTIFIED.
6. DIMENSIONS ARE IN INCHES AND METRIC.
7. TOLERANCE: .XX±.015 .XXX±.005 ANG.±2°  
GENERAL TOLERANCE DOES NOT APPLY.

THREAD- SEE "NOMINAL SIZE" TABLE BELOW.  
NOMINAL SIZE AND AGENCY APPROVALS IDENTIFIERS SHALL BE PERMANENTLY MARKED IN THESE LOCATIONS.

SUGGESTED CLEARANCE HOLE FOR NON-THREADED MOUNTING

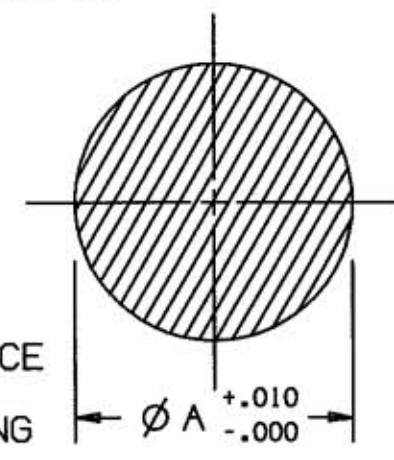

M-9041 3

LIST OF PARTS

DESCRIPTION	MATERIAL	FINISH
CORD CONNECTOR	SEE NOTES	

DIMENSION SHEET FOR CAT. NO. SEE TABLE  
 REPAIRABLE  NON-REPAIRABLE   
 B  
 M-9041  
 3

PART DIMENSIONS

CAT. NO.	NOMINAL SIZE	CABLE DIA. INCHES		CABLE DIA. METRIC		APPROVALS			Ø A CLEARANCE HOLE		-B- MAXIMUM LENGTH		-C- THREAD LENGTH		-D- WRENCHING NUT THK.		-E- WRENCHING FLATS		-F- SEALING NUT HGT.	
		MIN	MAX	MIN	MAX	CSA	UL	UR	IN.	MM	IN.	MM	IN.	MM	IN.	MM	IN.	MM	IN.	MM
SEC38GA	NPT 3/8	.181	.312	4.6	7.92	X		X	.680	17.3	1.41	35.8	0.49	12.4	0.21	5.3	0.83	21.0	0.55	14.0
SEC38BA	NPT 3/8	.181	.312	4.6	7.92	X		X	.680	17.3	1.41	35.8	0.49	12.4	0.21	5.3	0.83	21.0	0.55	14.0
SEC50GA	NPT 1/2	.170	.450	4.32	11.43	X	X		.875	22.2	1.70	43.2	0.61	15.5	0.21	5.3	0.98	24.9	0.66	16.8
SEC50BA	NPT 1/2	.170	.450	4.32	11.43	X	X		.875	22.2	1.70	43.2	0.61	15.5	0.21	5.3	0.98	24.9	0.66	16.8
SEC75GA	NPT 3/4	.450	.709	11.43	18.0	X	X		1.040	26.4	2.00	50.8	0.62	15.7	0.25	6.3	1.30	33.0	0.85	21.6
SEC75BA	NPT 3/4	.450	.709	11.43	18.0	X	X		1.040	26.4	2.00	50.8	0.62	15.7	0.25	6.3	1.30	33.0	0.85	21.6
SEC100GA	NPT 1	.590	1.000	14.99	25.4	X	X		1.328	33.7	2.41	61.2	0.76	19.3	0.30	7.6	1.73	43.9	1.05	26.7
SEC100BA	NPT 1	.590	1.000	14.99	25.4	X	X		1.328	33.7	2.41	61.2	0.76	19.3	0.30	7.6	1.73	43.9	1.05	26.7
SEC75RBPk1000	NPT 3/4	.250	.485	6.35	12.32	X	X		1.040	27.13	2.00	50.8	0.62	15.7	0.25	6.3	1.30	33.0	0.85	21.6
SEC38GPK2000	NPT 3/8	.181	.312	4.6	7.92	X		X	.680	17.3	1.41	35.8	0.49	12.4	0.21	5.3	0.83	21.0	0.55	14.0
SEC38BPK2000	NPT 3/8	.181	.312	4.6	7.92	X		X	.680	17.3	1.41	35.8	0.49	12.4	0.21	5.3	0.83	21.0	0.55	14.0
SEC50GPK1500	NPT 1/2	.170	.450	4.32	11.43	X	X		.875	22.2	1.70	43.2	0.61	15.5	0.21	5.3	0.98	24.9	0.66	16.8
SEC50BPK1500	NPT 1/2	.170	.450	4.32	11.43	X	X		.875	22.2	1.70	43.2	0.61	15.5	0.21	5.3	0.98	24.9	0.66	16.8
SEC75GPK1000	NPT 3/4	.450	.709	11.43	18.0	X	X		1.040	26.4	2.00	50.8	0.62	15.7	0.25	6.3	1.30	33.0	0.85	21.6
SEC75BPK1000	NPT 3/4	.450	.709	11.43	18.0	X	X		1.040	26.4	2.00	50.8	0.62	15.7	0.25	6.3	1.30	33.0	0.85	21.6
SEC38RGA	NPT 3/8	.069	.187	1.8	4.7	X		X	.680	17.3	1.41	35.8	0.49	12.4	0.21	5.3	0.83	21.0	0.55	14.0
SEC100BPK300	NPT 1	.590	1.000	14.99	25.4	X	X		1.328	33.7	2.41	61.2	0.76	19.3	0.30	7.6	1.73	43.9	1.05	26.7

SYM	REVISIONS	APP	DATE
3	ADDED SEC100BPK300 TO TABLE PER DCN11936.	JMN	8/19/04
2	ADDED SEC38RGA TO TABLE PER DCN11238 MYA	JPP	10-5-03
1	RELEASED PER DCN#10665	JVD	3-10-03

THE DESIGN AND DIMENSIONS OF THE PRODUCT SHOWN ON THIS DRAWING ARE SUBJECT TO CHANGE WITHOUT NOTICE

TITLE  
NPT TYPE CORD CONNECTORS  
CUSTOMER DRAWING

TOLERANCES UNLESS OTHERWISE SPECIFIED		WIRING DEVICE-KELLEMS HUBBELL INCORPORATED BRIDGEPORT, CT	
FRACTIONS	± 1/64	DR. BY PAC	APP. BY JVD
DECIMALS	± .005	TR. BY	SCALE 2-1
ANGLES	± 2°	CHK'D BY JVD	DATE 2-27-03