



CASTER CONNECTION

KEEPING BUSINESS IN MOTION®



up your caster



full of energy

The **CC Apex**'s high quality polyurethane tread stores and exudes energy unlike any other comparable wheel on the market. When force is exerted (by gravity, debris, pushing, or pulling) on the CC Apex, potential energy is built up in the wheel's resilient polyurethane tread and is rapidly released as kinetic energy during movement. The tread's unique composition assists in propelling the wheel, boosting pushing and pulling both before and during rolling, making the CC Apex an **excellent ergonomic choice**.

DID YOU KNOW?

The CC Apex is ergonomically designed to minimize push/pull and reduce work-related injuries

a sound wheel:

The polyurethane tread of the CC Apex embodies a unique mix of resiliency and durability, allowing the wheel to put out low decibel levels during movement. The wheel's quiet performance positions it as an excellent option for users that have low-noise initiatives, such as those in the healthcare and manufacturing industries.

- » The CC Apex's polyurethane tread is soft enough to absorb noise-causing vibration during rolling, but hard enough to not squeak while in motion

holds its own:

The CC Apex is capable of handling substantial weight loads without sacrificing performance in other areas. Each size of the CC Apex (4", 5", 6", 8", 10") has weight capacities that are competitive with comparable wheels, allowing it to hold its own in comparison tests. The combination of the wheel's high quality materials and construction allow it to handle the rigors of any recommended use.

- » Weight capacities per wheel diameter are featured on page 7 of this brochure

ergonomically efficient:

You won't find a more ergonomic wheel that offers the combination of benefits that the CC Apex does. The mixture of perfect tread durometer, resiliency, shape and weight capacity give the wheel the ability to roll *and* maneuver easily.

- » The high quality polyurethane gives an extra boost to the effort exerted during pushing and pulling
- » The sturdy-yet-lightweight aluminum core won't overheat and won't bog down movement

for your health: donut-shaped tread

The CC Apex's unique polyurethane tread features a donut shape that offers smooth maneuverability, even under heavy weight loads. This is yet another factor that helps make the CC Apex a great option for users who want to reduce the risk of injury to their associates, thus reducing downtime and workers' compensation claims.

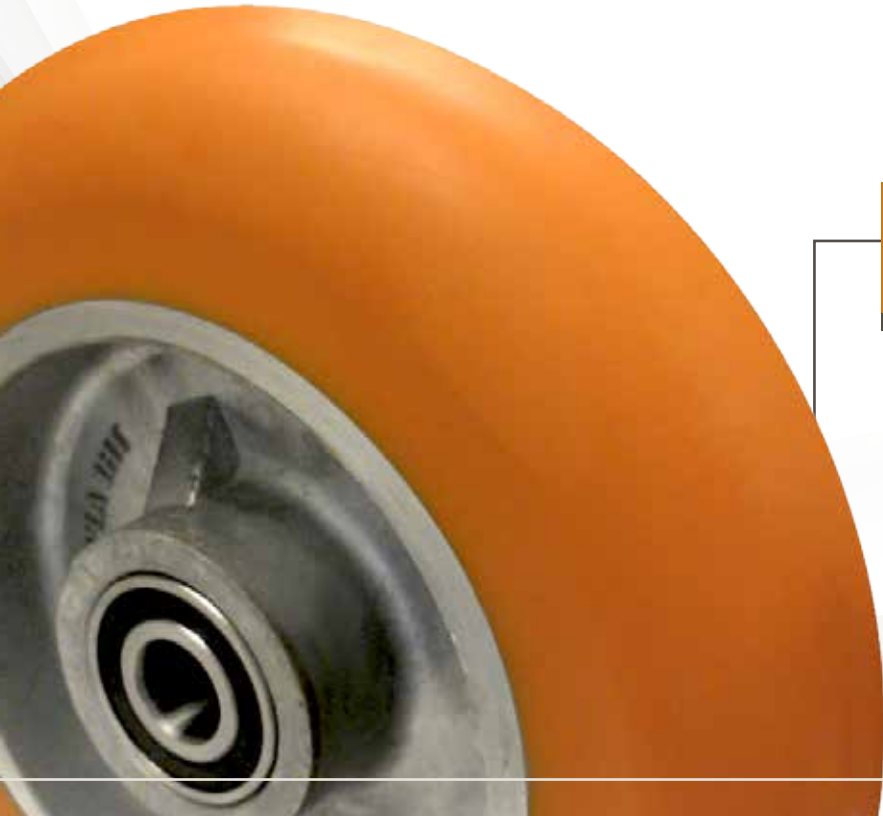

effortlessly dispel debris



What happens when you **don't** choose CC Apex

Automotive plants operate some of the most rigorous applications in the material handling world. Many of these applications run non-stop, meaning there isn't time for repair to casters, flooring, or equipment. This requirement makes it extremely important to understand the application and environment so that the correct casters are implemented into the field.

The CC Apex's durometer (level of hardness) and resiliency are made specifically for environments where debris is present, meaning weld slag, metal chips and other debris don't stand a chance. The high quality polyurethane tread of the wheel dispels debris no matter what - even during constant movement. Because of its perfect polyurethane formulation, the CC Apex **does not** pick up debris - *unlike the wheel shown at the top left* - saving your flooring, and saving you from downtime.



Protects floors and dispels debris



Skid resistant for towline applications



Maintenance-Free, Double-Sealed Precision Ball Bearing, ideal for higher speeds and frequent turns

terrific in towlines

Towline applications require casters with wheels that are hard enough to handle high weight capacities and soft enough to dispel debris and maintain grip on flooring while maneuvering at high speeds. The CC Apex is capable of meeting all of these requirements because of its unique polyurethane tread. In addition to these capabilities, the CC Apex does not overheat easily during high speed towing because of its aluminum core and because it features a precision ball bearing, which is an ideal bearing for casters in environments that require optimal maneuverability. The list of Fortune 500 users and numerous CC Apex success stories will give you the confidence you need to implement the CC Apex into your applications.

you may not have heard...

“With [our old] steel wheels, our employees had to really lean into the loaded carts to get them to roll. With the CC Apex wheels, [the carts] have [practically] been rolling away by themselves... As [advertised], these wheels do not pick up metal chips even when rolled through an area that is covered with chips. Our employees are very pleased with the wheels, so much that many are asking when their department will be upgraded!”

—Kevin G., Manufacturing and Design

“We have had tremendous success with the CC Apex wheel. They have been in the field for over a year now with no problems at all. We have recommended it to several manufacturing companies that we have partnerships with.”

—Richard C., Assembly Conveyance Specialist

“After trialing [CC Apex] wheels on [their] two carts, the [hospital] maintenance team gave ‘rave reviews’ about the CC Apex, noting a great reduction in noise and a smoother, easier moving cart.”

—Excerpt from CC Apex success story

CC Apex product specs

CC Apex 4" x 2"

Part #	Description	Diameter	Tread Width	Overall Height	Capacity
49H862	4 X 2 RIGID CASTER	4"	2"	5-5/8"	650 LBS.
49H860*	4 X 2 KINGPINLESS SWIVEL CASTER	4"	2"	5-5/8"	650 LBS.
49H861**	4 X 2 KINGPINLESS EXTENDED SWIVEL CASTER	4"	2"	5-5/8"	650 LBS.
49H856	4 X 2 WHEEL w/ TOP HATS	4"	2"	N/A	650 LBS.

CC Apex 5" x 2"

Part #	Description	Diameter	Tread Width	Overall Height	Capacity
49H864	5 X 2 RIGID CASTER	5"	2"	6-1/2"	750 LBS.
49H863*	5 X 2 KINGPINLESS SWIVEL CASTER	5"	2"	6-1/2"	750 LBS.
45XC21**	5 X 2 KINGPINLESS EXTENDED SWIVEL CASTER	5"	2"	6-1/2"	750 LBS.
49H857	5 X 2 WHEEL w/ TOP HATS	5"	2"	N/A	750 LBS.



* Kingpinless/Maintenance Free – Elimination of kingpin eliminates the number one cause of swivel caster failure, the kingpin.

** Extended Lead – Swivel lead is extended to help eliminate chatter and ease swivel ability. Swivel lead is the distance from the vertical centerline of the swivel section to the vertical centerline of the wheel.

*** Large Top Plate = 4-1/2" x 6-1/4" ; Standard Top Plates = 4" x 4-1/2"

CC Apex 6" x 2"

Part #	Description	Diameter	Tread Width	Overall Height	Capacity
49H867	6 X 2 RIGID CASTER	6"	2"	7-1/2"	1000 LBS.
49H865*	6 X 2 KINGPINLESS SWIVEL CASTER	6"	2"	7-1/2"	1000 LBS.
49H866**	6 X 2 KINGPINLESS EXTENDED SWIVEL CASTER	6"	2"	7-1/2"	1000 LBS.
49H858	6 X 2 WHEEL w/ TOP HATS	6"	2"	N/A	1000 LBS.

CC Apex 8" x 2"

Part #	Description	Diameter	Tread Width	Overall Height	Capacity
49H870	8 X 2 RIGID CASTER	8"	2"	9-1/2"	1200 LBS.
19YW82*	8 X 2 KINGPINLESS SWIVEL CASTER	8"	2"	9-1/2"	1200 LBS.
49H869**	8 X 2 KINGPINLESS EXTENDED SWIVEL CASTER	8"	2"	9-1/2"	1200 LBS.
38GV52**	8 X 2 KINGPINLESS EXTENDED SWIVEL CASTER w/ BRAKE	8"	2"	9-1/2"	1200 LBS.
45XC16	8 X 2 RIGID CASTER (LARGE TOP PLATE***)	8"	2"	9-1/2"	1200 LBS.
45XC14**	8 X 2 KINGPINLESS SWIVEL CASTER (LARGE TOP PLATE***)	8"	2"	9-1/2"	1200 LBS.
45XC15**	8 X 2 KINGPINLESS EXTENDED SWIVEL CASTER (LARGE TOP PLATE***)	8"	2"	9-1/2"	1200 LBS.
19YW81	8 X 2 RIGID CASTER	8"	2"	10-1/8"	1200 LBS.
19YW83*	8 X 2 KINGPINLESS SWIVEL CASTER	8"	2"	10-1/8"	1200 LBS.
49H868**	8 X 2 KINGPINLESS EXTENDED SWIVEL CASTER	8"	2"	10-1/8"	1200 LBS.
19YW84	8 X 2 RIGID CASTER (LARGE TOP PLATE***)	8"	2"	10-1/8"	1200 LBS.
19YW85*	8 X 2 KINGPINLESS SWIVEL CASTER (LARGE TOP PLATE***)	8"	2"	10-1/8"	1200 LBS.
19YW86**	8 X 2 KINGPINLESS EXTENDED SWIVEL CASTER (LARGE TOP PLATE***)	8"	2"	10-1/8"	1200 LBS.
36HW78	8 X 2 HEAVY-DUTY RIGID CASTER (LARGE TOP PLATE***)	8"	2"	10-1/8"	1200 LBS.
36HW77**	8 X 2 HEAVY-DUTY MAINTENANCE-FREE EXTENDED SWIVEL CASTER (LARGE TOP PLATE***)	8"	2"	10-1/8"	1200 LBS.
49H859	8 X 2 WHEEL w/ TOP HATS	8"	2"	N/A	1200 LBS.

lean, just as mean

introducing the 1.25" wide CC Apex



At Caster Connection, we pride ourselves on our ability to understand our clients' needs and to develop and recommend the best solutions possible.

Our line of 2" wide CC Apex casters and wheels have long been recognized as the gold standard for many industries and applications, and we are proud to also offer the CC Apex's availability in 1.25" wide treads. This tread width offering will allow users of 1.25" wide casters to experience the same amazing benefits that the 2" wide CC Apex has offered for years.

Perfect for medical environments, food service and more!

ORANGE 1.25" WIDE CC APEX SIZE CHARTS*

CC Apex 4" x 1.25"

Part #	Description	Diameter	Tread Width	Overall Height	Capacity
45XC26	4 X 1-1/4 ORANGE RIGID CASTER	4"	1.25"	5-1/8"	400 LBS.
45XC24	4 X 1-1/4 ORANGE SWIVEL CASTER	4"	1.25"	5-1/8"	400 LBS.
45XC25	4 X 1-1/4 ORANGE SWIVEL CASTER w/ TOTAL LOCK BRAKE	4"	1.25"	5-1/8"	400 LBS.
45XC22	4 X 1-1/4 ORANGE WHEEL ONLY	4"	1.25"	N/A	400 LBS.



*Available in stem mount
(Contact Us)

CC Apex 5" x 1.25"

Part #	Description	Diameter	Tread Width	Overall Height	Capacity
45XC29	5 X 1-1/4 ORANGE RIGID CASTER	5"	1.25"	6-1/4"	450 LBS.
45XC27	5 X 1-1/4 ORANGE SWIVEL CASTER	5"	1.25"	6-1/4"	450 LBS.
45XC28	5 X 1-1/4 ORANGE SWIVEL CASTER w/ TOTAL LOCK BRAKE	5"	1.25"	6-1/4"	450 LBS.
45XC23	5 X 1-1/4 ORANGE WHEEL ONLY	5"	1.25"	N/A	450 LBS.



All casters on this page feature a 2-5/8" x 3-5/8" top plate.

1.800.544.8978 : www.casterconnection.com

need something a bit more *Stout*?

CC Stout casters and wheels are an excellent option for those who need to carry heavy weight loads with great ergonomic ease while also capably rejecting debris and reducing downtime due to failed casters, damaged flooring or injured employees. CC Stout caster wheels function so incredibly well during pushing and pulling because they feature the **same polyurethane tread as the industry-changing CC Apex**, chemically bonded to a stout, cast iron core. All CC Stout wheels include a maintenance-free, sealed precision ball bearing for peak performance in applications that entail frequent halts, jolts and jerks.

CC Stout casters and wheels provide the following benefits:

- high weight capacity
- low push/pull force necessary for movement
- ergonomic and easily controllable
- debris dispersing capability
- holds up under rigorous conditions
- reduces downtime and repair costs
- painted iron core to protect structural integrity
- orange wheel tread for easy visibility

CC Stout casters work well in environments that include:

- debris
- delicate flooring
- restricted space for maneuverability
- thresholds
- weld slag
- nails and/or metal chips



CC Stout product specs

resilient polyurethane tread
+
cast iron core
+
sealed precision ball bearing



CC Stout 6" x 3"

Part #	Description	Diameter	Tread Width	Overall Height	Capacity
36HW72	6 X 3 RIGID CASTER (LARGE TOP PLATE***)	6"	3"	7-1/2"	2300 LBS.
36HW71*	6 X 3 KINGPINLESS SWIVEL CASTER (LARGE TOP PLATE***)	6"	3"	7-1/2"	2300 LBS.
36HW68	6 X 3 WHEEL w/ TOP HATS	6"	3"	N/A	2300 LBS.

CC Stout 8" x 3"

Part #	Description	Diameter	Tread Width	Overall Height	Capacity
36HW74	8 X 3 RIGID CASTER (LARGE TOP PLATE***)	8"	3"	10-1/8"	2500 LBS.
36HW73*	8 X 3 KINGPINLESS SWIVEL CASTER (LARGE TOP PLATE***)	8"	3"	10-1/8"	2500 LBS.
36HW69	8 X 3 WHEEL w/ TOP HATS	8"	3"	N/A	2500 LBS.

CC Stout 10" x 3"

Part #	Description	Diameter	Tread Width	Overall Height	Capacity
36HW76	10 X 3 RIGID CASTER (LARGE TOP PLATE***)	10"	3"	11-1/2"	2750 LBS.
36HW75*	10 X 3 KINGPINLESS SWIVEL CASTER (LARGE TOP PLATE***)	10"	3"	11-1/2"	2750 LBS.
36HW70	10 X 3 WHEEL w/ TOP HATS	10"	3"	N/A	2750 LBS.



* Kingpinless/Maintenance Free – Elimination of kingpin eliminates the number one cause of swivel caster failure, the kingpin.

*** Large Top Plate = 4-1/2" x 6-1/4" ; Standard Top Plates = 4" x 4-1/2"

battle-tested nylex

The **Heavy Duty Nylon CC Nylex Wheel** is a superb ergonomic choice for carrying very heavy weight loads. Providing impact absorption and sheer strength components without breakdown, the CC Nylex has an outstanding ability to roll with ease. Its slight crown and hard tread design grant users boundless mobility and performs almost exclusively maintenance-free.

The benefits of the CC Nylex include:

- ability to handle heavy weight loads without breakdown
- impressive impact absorption
- low push-pull force required for movement
- smooth maneuverability with little to no interruption
- resistance to organic diluters, including most cleaning & chemical solutions



CC Nylex product specs

CC Nylex 4" x 2"

Part #	Description	Diameter	Tread Width	Overall Height	Capacity
45XA98	4 X 2 RIGID CASTER	4"	2"	5-1/8"	1000 LBS.
45XA96*	4 X 2 KINGPINLESS SWIVEL CASTER	4"	2"	5-1/8"	1000 LBS.
45XA97**	4 X 2 KINGPINLESS EXTENDED SWIVEL CASTER	4"	2"	5-1/8"	1000 LBS.
45XA92	4 X 2 WHEEL w/ TOP HATS	4"	2"	N/A	1000 LBS.



CC Nylex 6" x 2"

Part #	Description	Diameter	Tread Width	Overall Height	Capacity
45XC04	6 X 2 RIGID CASTER	6"	2"	7-1/2"	1500 LBS.
45XC02*	6 X 2 KINGPINLESS SWIVEL CASTER	6"	2"	7-1/2"	1500 LBS.
45XC03**	6 X 2 KINGPINLESS EXTENDED SWIVEL CASTER	6"	2"	7-1/2"	1500 LBS.
45XA94	6 X 2 WHEEL w/ TOP HATS	6"	2"	N/A	1500 LBS.

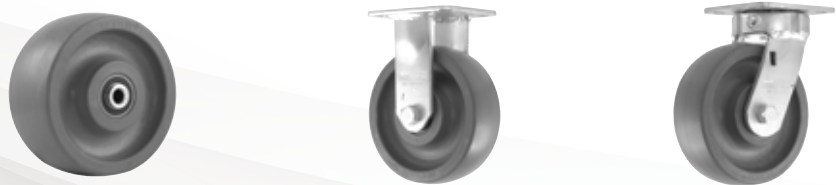

* Kingpinless/Maintenance Free – Elimination of kingpin eliminates the number one cause of swivel caster failure, the kingpin.

** Extended Lead – Swivel lead is extended to help eliminate chatter and ease swivel ability. Swivel lead is the distance from the vertical centerline of the swivel section to the vertical centerline of the wheel.

*** Large Top Plate = 4-1/2" x 6-1/4" ; Standard Top Plates = 4" x 4-1/2"

CC Nylex 5" x 2"

Part #	Description	Diameter	Tread Width	Overall Height	Capacity
45XC01	5 X 2 RIGID CASTER	5"	2"	6-1/2"	1250 LBS.
45XA99*	5 X 2 KINGPINLESS SWIVEL CASTER	5"	2"	6-1/2"	1250 LBS.
45XC20**	5 X 2 KINGPINLESS EXTENDED SWIVEL CASTER	5"	2"	6-1/2"	1250 LBS.
45XA93	5 X 2 WHEEL w/ TOP HATS	5"	2"	N/A	1250 LBS.

CC Nylex 8" x 2"

Part #	Description	Diameter	Tread Width	Overall Height	Capacity
45XC07	8 X 2 RIGID CASTER	8"	2"	9-1/2"	2000 LBS.
45XC05*	8 X 2 KINGPINLESS SWIVEL CASTER	8"	2"	9-1/2"	2000 LBS.
45XC06**	8 X 2 KINGPINLESS EXTENDED SWIVEL CASTER	8"	2"	9-1/2"	2000 LBS.
45XC19**	8 X 2 RIGID CASTER (LARGE TOP PLATE***)	8"	2"	9-1/2"	2000 LBS.
45XC17*	8 X 2 KINGPINLESS SWIVEL CASTER (LARGE TOP PLATE***)	8"	2"	9-1/2"	2000 LBS.
45XC18**	8 X 2 KINGPINLESS EXTENDED SWIVEL CASTER (LARGE TOP PLATE***)	8"	2"	9-1/2"	2000 LBS.
45XC10	8 X 2 RIGID CASTER	8"	2"	10-1/8"	2000 LBS.
45XC08*	8 X 2 KINGPINLESS SWIVEL CASTER	8"	2"	10-1/8"	2000 LBS.
45XC09**	8 X 2 KINGPINLESS EXTENDED SWIVEL CASTER	8"	2"	10-1/8"	2000 LBS.
45XC13	8 X 2 RIGID CASTER (LARGE TOP PLATE***)	8"	2"	10-1/8"	2000 LBS.
45XC11*	8 X 2 KINGPINLESS SWIVEL CASTER (LARGE TOP PLATE***)	8"	2"	10-1/8"	2000 LBS.
45XC12**	8 X 2 KINGPINLESS EXTENDED SWIVEL CASTER (LARGE TOP PLATE***)	8"	2"	10-1/8"	2000 LBS.
45XA95	8 X 2 WHEEL w/ TOP HATS	8"	2"	N/A	2000 LBS.

1.800.544.8978 : www.casterconnection.com

CC-wheels and CC-series rigs: a perfect pairing

The CC Apex and CC Stout are excellent caster wheels for those concerned with ergonomics, durability, noise levels and use in towlines, but it can't be used on its own – you need a rig too! That's why we recommend pairing the CC Apex with the awesome line of CC-series rigs: **CC Alpha** and **CC Peak**.

The **CC Alpha** is a kingpinless caster rig that can handle heavy weight loads, performs well in towlines and offers great durability because of its lack of a kingpin. Without the kingpin, a caster is able to more evenly distribute weight and ease the pressure on the raceway. Casters with a kingpin often fail in towline applications. High-velocity towing can wear down the kingpin and cause catastrophic failure.

The **CC Peak** blows the competition away! This maintenance-free caster rig's construction allows for even dispersion of load, which has an incredibly dramatic effect in reducing push-pull compared to other caster rigs. The CC Peak's robust ergonomic design can face the harshest environments of any recommended use, requires no maintenance (because of its sealed raceway and lifelong grease) and dramatically reduces push-pull force requirements.

Want to get rolling? Contact us for more information regarding *your* perfect pairing.



CC Alpha and CC Peak are available in a variety of top plates and overall heights

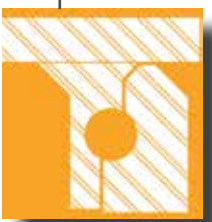
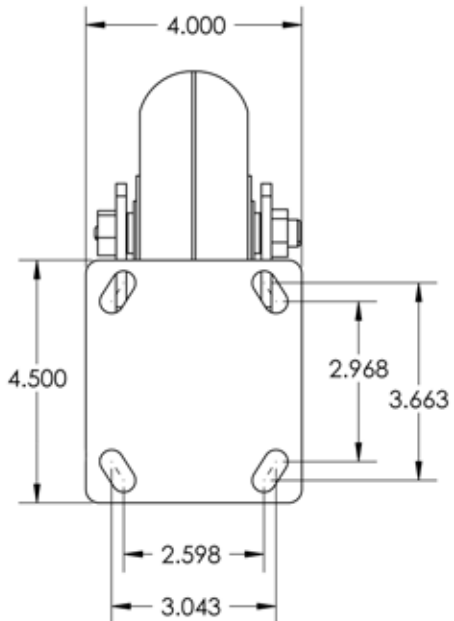

CC Alpha kingpinless caster rig, ideal for towlines

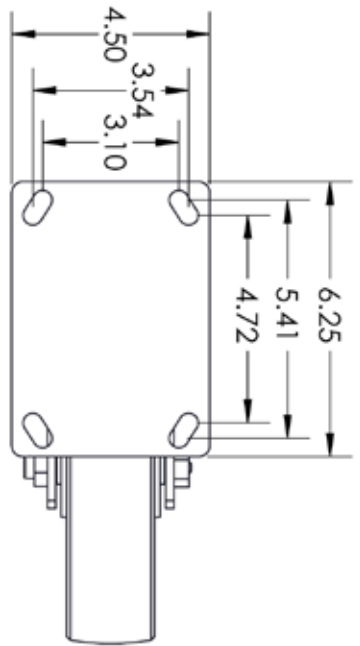

CC Peak maintenance-free caster rig greatly lowers required push/pull, excellent in towlines, requires no maintenance





AVAILABLE THROUGH

GRAINGER®

FOR THE ONES WHO GET IT DONE

For more information, contact your Grainger Representative or visit Grainger.com®.

8SS6119